

PCB LAYOUT
S=2:1

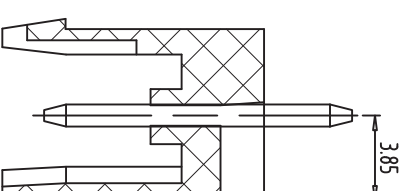

SECTION:A-A

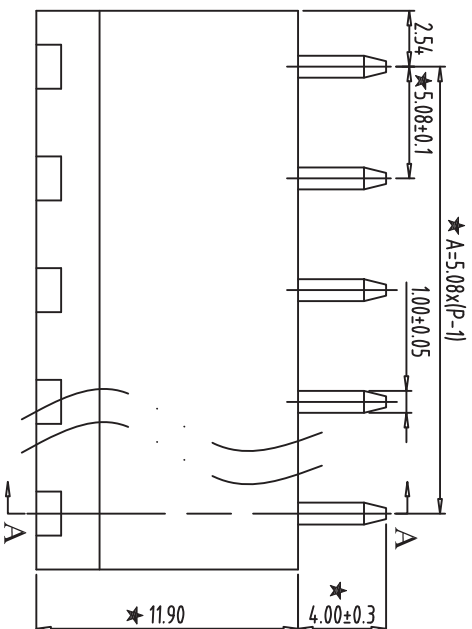
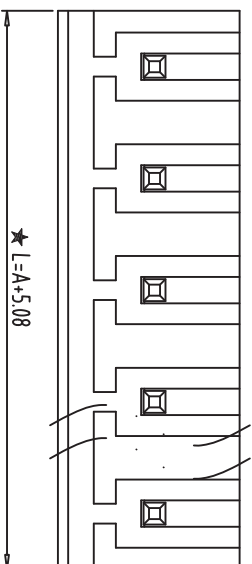
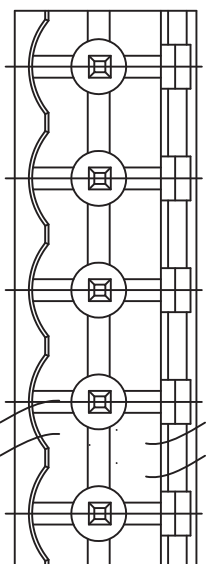
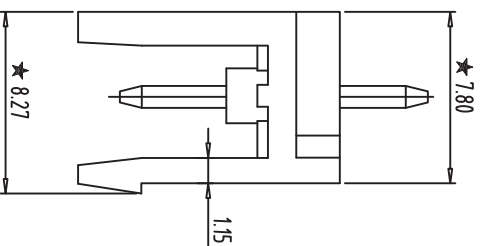

- NOTES:
1. Rating:300V 15A ;
 2. Insulation Withstands Voltage: AC2000V/MIN
 3. Insulation Resistance: 500M Ω or more at DC500V
 4. Using Temperature Range: -40°C~+105°C
 5. “ \star ” is the important dimension
 6. RoHS compliance

Total Pitch Tolerances		Nominal dimension range																														
In mm		In mm																														
0	to	0	to	30	to	53	to	70	to	90	to	115	to	150	to	200	to	250	to	320	to	400	to	500	to	630	to	800	to	1000		
±0.18	to	±0.20	to	±0.25	to	±0.3	to	±0.35	to	±0.44	to	±0.50	to	±0.60	to	±0.70	to	±0.85	to	±1.00	to	±1.25	to	±1.50	to	±2.00	to	±2.50	to	±3.15	to	±4.00

ITEM	NAME OF PART	NO. OF PART	Q'TY	MATERIAL	NOTE
DWG	SK	DATE	2014/08/19	SIZE	A4
CHK	DATE			SCALE	3:1
APP.	DATE			SCALE	2EDG-5.08

深圳市金航标电子有限公司
KH-F400V-10P-5.08G
WWW.BDS666.COM
0755-83044319